

RIVIAL

Via G. Pastore,11 43058 SORBOLO (PR) - ITALIA

AUTOMATIC LUBRICATING PUMP AT 1 DELIVERY

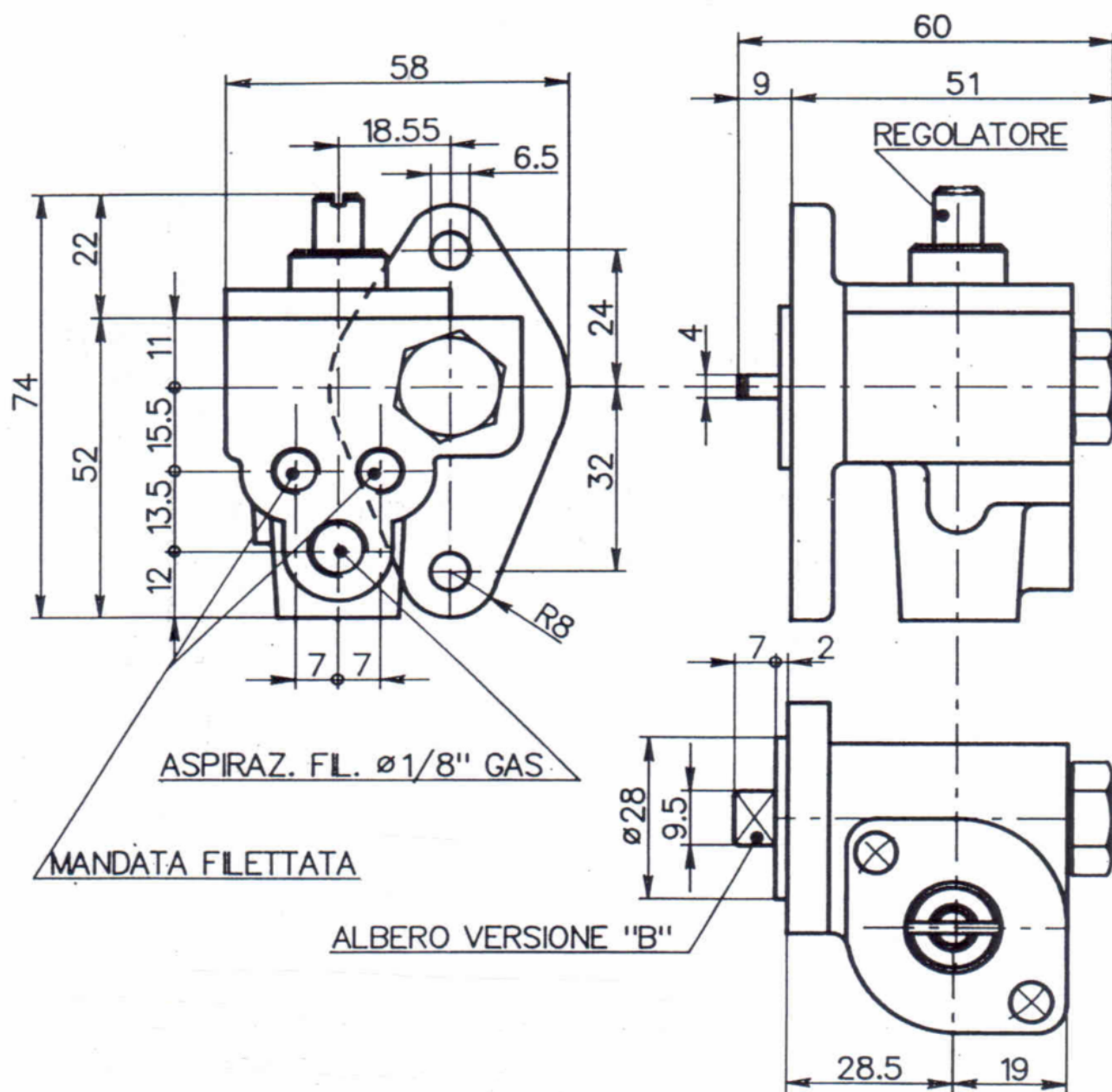

RIVIAL

Via G. Pastore,11 43058 SORBOLO (PR) - ITALIA

AUTOMATIC LUBRICATING PUMP AT 1 DELIVERY

TECHNICAL DATA AND INSTRUCTIONS

Total capacity	g/h	0-360
Max rev.	n/min	2000
Ratio	R	33:1
Delivieries	N°	1
Max pressure	bar	2,5
Max suction height	mm	250
Piston diam.	mm	7,17
Suction hose diam.	mm	6x4
Delivery hose diam.	mm	4x2
Weight	kg	0,570
Delivery hole	/	1/8" G
Suction hole	/	1/8" G

HOW TO USE IT

The automatic lubrication pump doesn't require any special maintenance during operation.

Always make sure to have oil into the machine feed tank and at least every 5-6 months check lubricating oil/grease level into the pump tank under the cover; if required add oil/grease without completely fill the tank.

LUBRICATING FLOW CONTROL

In case you need a lower or higher oil delivery, operate the register pin. Turn clockwise to have a lower oil delivery (-); turn anticlockwise to have a higher oil delivery (+).

In order to do this operation unscrew the cover and unloosen the nut.

RIVIAL

Via G. Pastore,11 43058 SORBOLO (PR) - ITALIA

AUTOMATIC LUBRICATING PUMP AT 1 DELIVERY

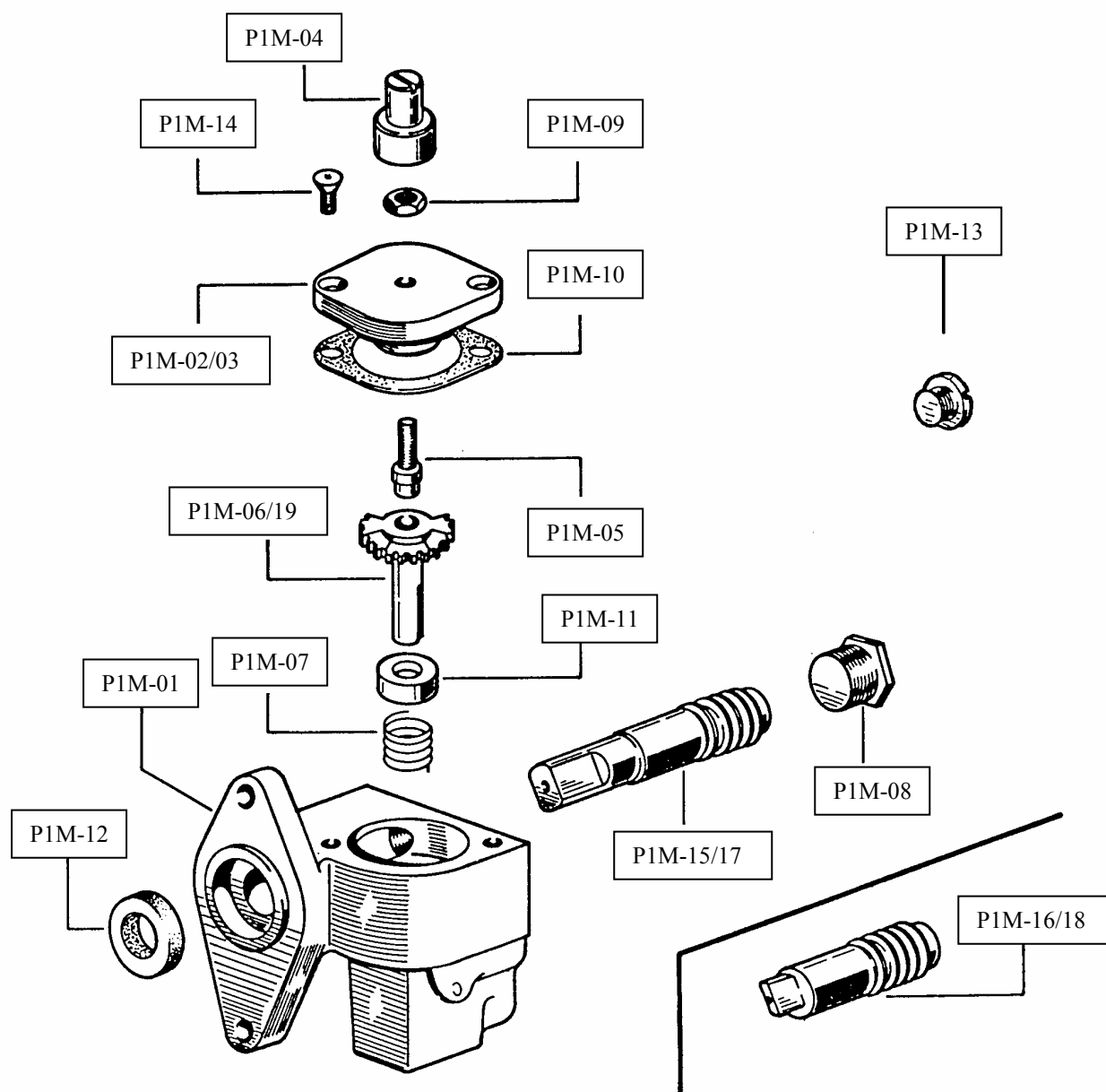

RIVIAL

Via G. Pastore,11 43058 SORBOLO (PR) - ITALIA

AUTOMATIC LUBRICATING PUMP AT 1 DELIVERY

SPARE PARTS CATALOGUE AUTOMATIC LUBRICATING PUMP AT 1 DELIVERY

ART.	DESIGN	DESCRIPTION	PCS.
P1M-01	1603/J	A.L. 1 DELIVERY PUMP CASE	1
P1M-02	1623DX	PUMP COVER- RIGHT	1
P1M-03	1625SX	PUMP COVER LEFT	1
P1M-04	1632	REGISTER PIN COVER	1
P1M-05	1605	REGISTER PIN	1
P1M-06	1630DX	TIMING GEAR- RIGHT	1
P1M-07	1602	SPRING	1
P1M-08	1609	BACK PLUG	1
P1M-09	1610	NUT	1
P1M-10	1608	PUMP COVER GASKET	1
P1M-11	1612	SPRING SUPPORT	1
P1M-12	1613	OIL SEAL UNIT	1
P1M-13	1626	DELIVERY CLOSURE PLUG	1
P1M-14	1614	SCREW M4X0,7	2
P1M-15	1621DX	LONG TIMING SHAFT- RIGHT	1
P1M-16	1622DX	SHORT TIMING SHAFT- RIGHT	1
P1M-17	1621SX	LONG TIMING SHAFT - LEFT	1
P1M-18	1622SX	SHORT TIMING SHAFT- LEFT	1
P1M-19	1630SX	TIMING GEAR- LEFT	1