

RIVIAL

Via G. Pastore, 11 43058 SORBOLO (PR) - ITALIA

AUTOMATIC LUBRICATING PUMP AT 6 DELIVERIES

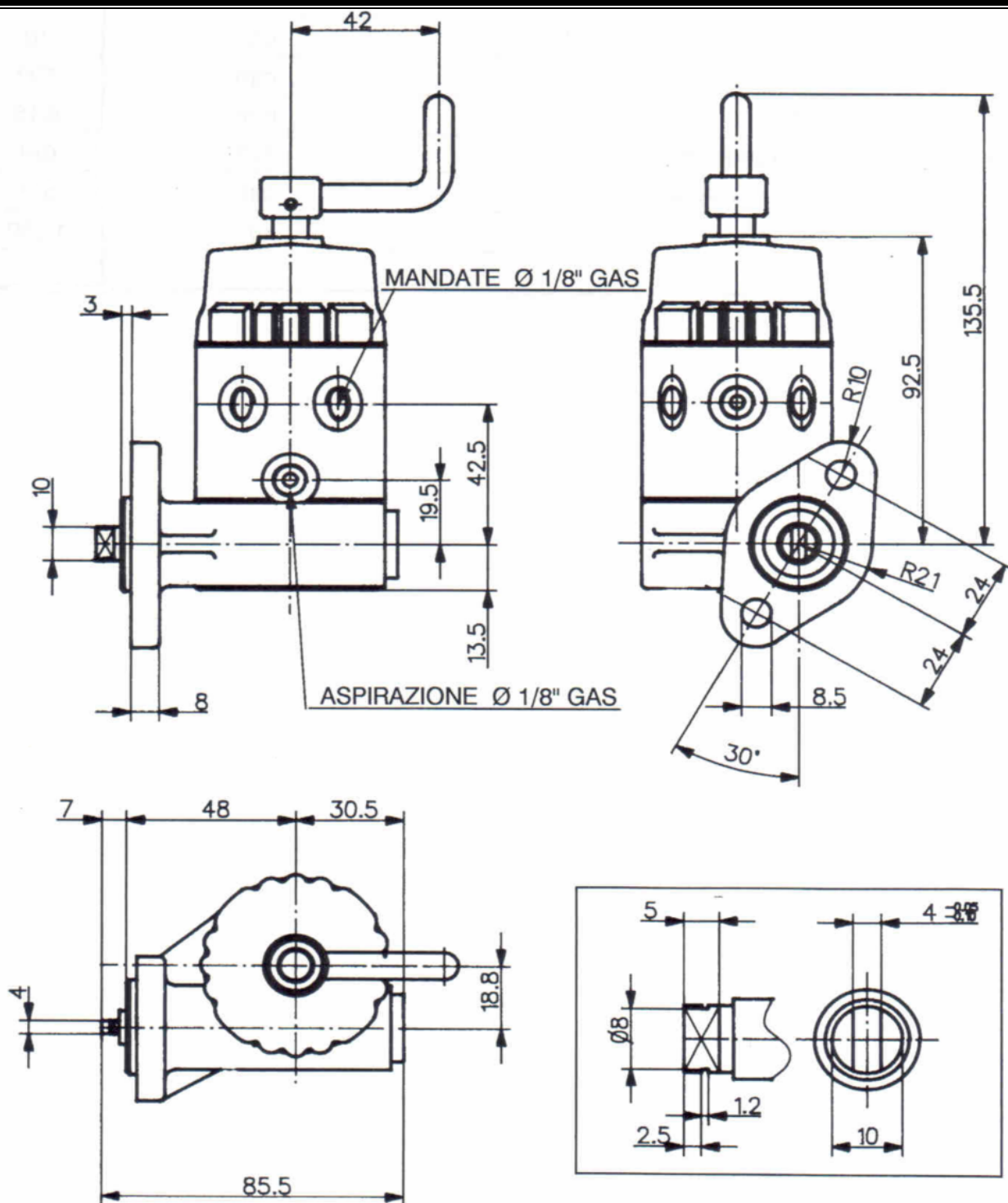

RIVIAL

Via G. Pastore,11 43058 SORBOLO (PR) - ITALIA

AUTOMATIC LUBRICATING PUMP AT 6 DELIVERIES

TECHNICAL DATA AND INSTRUCTIONS

Total capacity	g/h	
Min rev.	n/min	150
Max rev.	n/min	1400
Ratio	R	36:1
Deliveries	N°	6
Max pressure	bar	10
Max suction height	mm	500
Piston diam.	mm	6,15
Suction hose diam.	mm	6x4
Delivery hose diam.	mm	6x4
Weight	kg	1,050

HOW TO USE IT

The automatic lubrication pump doesn't require any special maintenance during operation. Always make sure to have oil into the machine feed tank and at least every 5-6 months check lubricating oil/grease level into the pump tank under the cover; if required add oil/grease without completely fill the tank.

LUBRICATING FLOW CONTROL

In case you need a lower or higher oil delivery, operate the register pin. Turn clockwise to have a lower oil delivery (-); turn anticlockwise to have a higher oil delivery (+).

In order to do this operation unscrew the cover and loosen the nut.

RIVIAL

Via G. Pastore,11 43058 SORBOLO (PR) - ITALIA

AUTOMATIC LUBRICATING PUMP AT 6 DELIVERIES

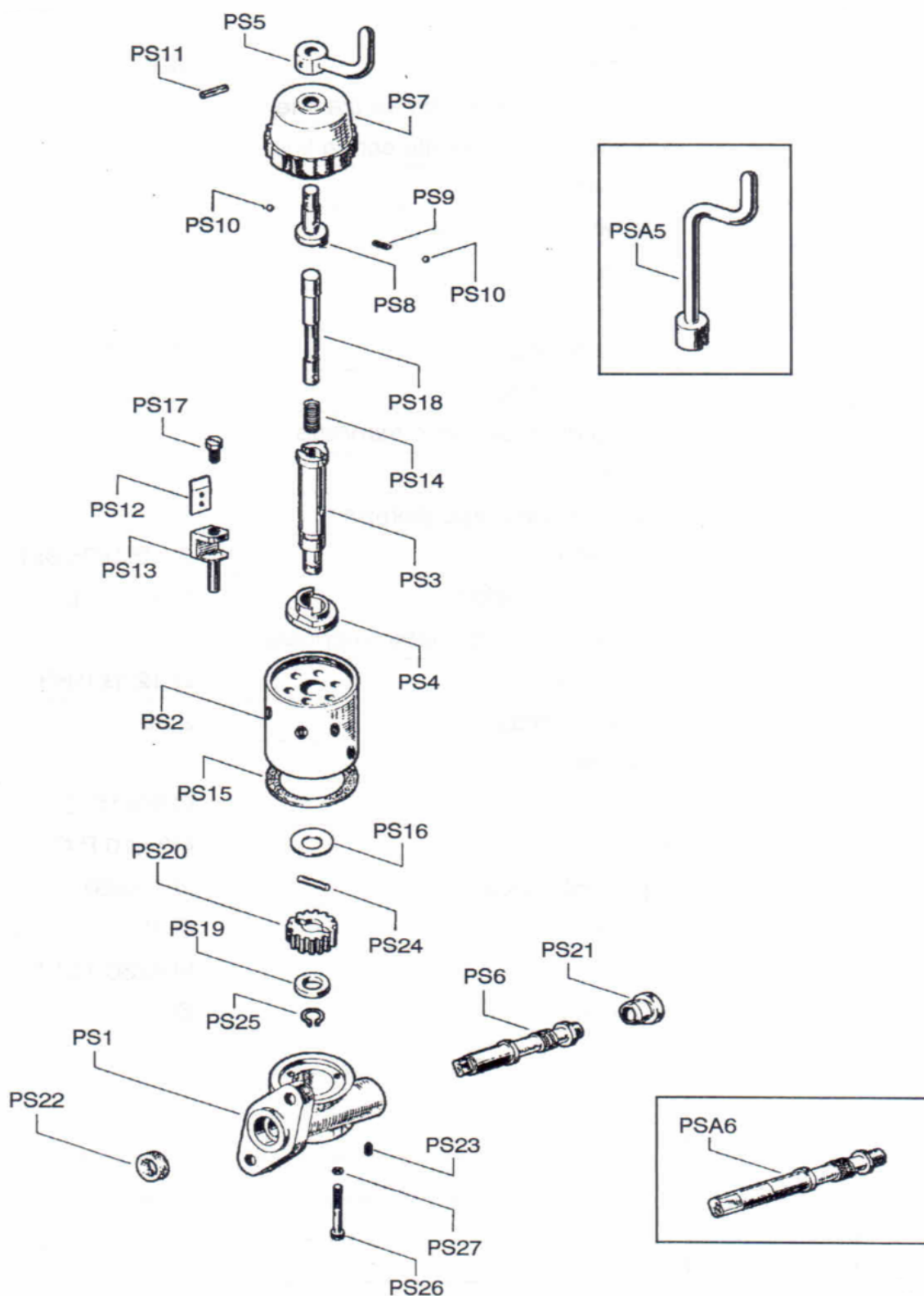

RIVIAL

Via G. Pastore,11 43058 SORBOLO (PR) - ITALIA

AUTOMATIC LUBRICATING PUMP AT 6 DELIVERIES

SPARE PARTS AUTOMATIC LUBRICATING PUMP AT 6 DELIVERIES

ART.	DESIGN	DESCRIPTIONS	PCS.
PS1	1005	PUMP CASE SUPPORT	1
PS2	1006	PUMP CASE	1
PS3	1007	TIMING SHAFT	1
PS4	1016	DELIVERY REGULATOR	1
PS5	1032	HANDLE	1
PSA5	1020	HANDLE	1
PS6	1031	SHORT SHAFT WITH ENDLESS SCREW	1
PSA6	1018	LONG SHAFT WITH ENDLESS SCREW	1
PS7	1026	COVER	1
PS8	1017	PIN WITH HANDLE	1
PS9	/	SPRING	1
PS10	/	SPHERE	2
PS11	1022	PIN	1
PS12	1030	BLOCKING FAKE	6
PS13	1015	DELIVERY REGULATOR PIN	6
PS14	1010	RETURN SPRING	1
PS15	1009	PUMP COVER GASKET	1
PS16	1013	WASHER	1
PS17	1014	REGULATING SCREW	6
PS18	1008	SHAFT FOR MANUAL FILLING	1
PS19	1012	DISTANCE WASHER	1
PS20	1019	RING GEAR	1
PS21	1011	BUSHING	1
PS22	/	OIL SEAL UNIT	1
PS23	/	SET SCREW	1
PS24	1021	CYLINDRICAL PIN	1
PS25	/	SEEGER	1
PS26	/	SCREW	3
PS27	/	WASHER	3